

Hardware Quick Reference LANCOM GS-2412

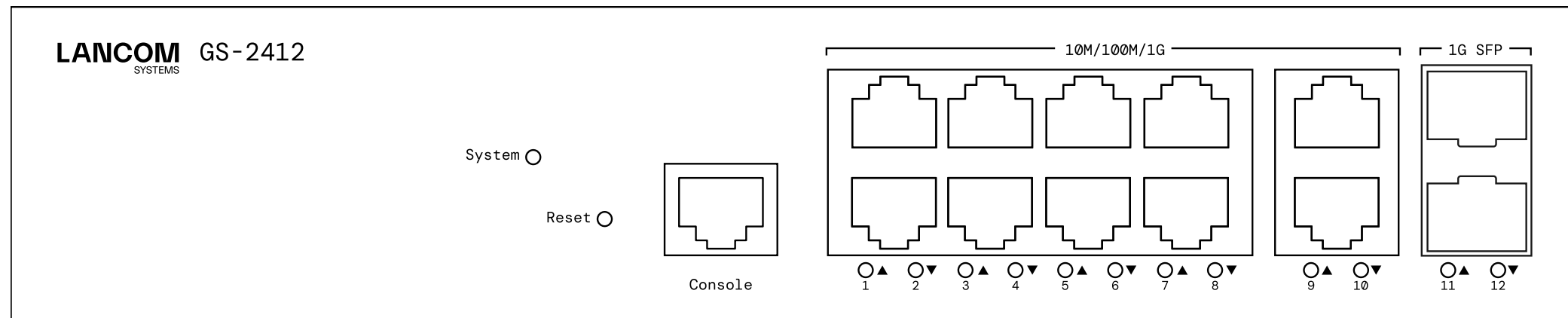

- ① **Configuration interface (Console)**
Connect the serial interface via the included serial configuration cable to the serial interface of the device you want to use for configuring / monitoring the switch.
- ② **TP Ethernet interfaces 10M / 100M / 1G**
Use Ethernet cables to connect the interfaces ETH 1 to ETH 10 to your PC or a LAN switch.

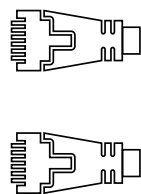

- ③ **SFP interfaces 1G**
Insert suitable LANCOM SFP transceivers into the SFP ports 11 and 12. Choose cables which are compatible with the SFP transceivers and connect them as described in the transceiver's documentations.
- ④ **Power connector (device back side)**
Supply power to the device via the power connector. Please use the IEC power cable supplied or a country-specific LANCOM Power Cord.

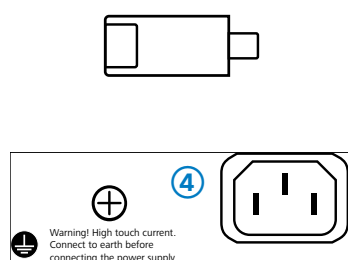

Before initial startup, please make sure to take notice of the information regarding the intended use in the enclosed installation guide!

Operate the device only with a professionally installed power supply at a nearby power socket that is freely accessible at all times.

All power plugs of the device must be freely accessible.

Please note that support for third-party accessories is not provided.



Please observe the following when setting up the device

- The power plug of the device must be freely accessible.
- For devices to be operated on the desktop, please attach the adhesive rubber footpads
- Do not rest any objects on top of the device
- Keep all ventilation slots on the side of the device clear of obstruction
- Mount the device into a 19" unit in a server cabinet using the provided screws and mounting brackets.
- Please note that support service for third-party accessories is excluded.

Mounting & connecting

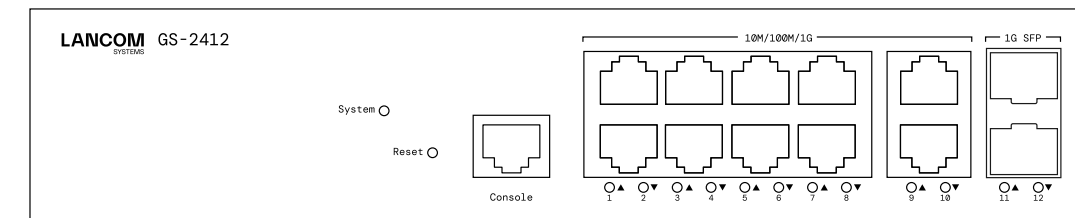

A System	
System: off	Device powered off
System: green	Device operational

C TP Ethernet ports	
Off	Port inactive
Green	Link 1000 Mbps
Orange	Link ≤ 100 Mbps

B Reset button	
5 seconds pressed	Restart of the device
10 seconds pressed	Reset and restart of the device

D SFP ports	
Off	Port inactive
Green	Link 1000 Mbps
Orange	Link ≤ 100 Mbps

Hardware	
Power supply	Internal power supply unit (110–230 V, 50-60 Hz)
Power consumption	Max. 14 watts
Environment	Temperature range 0–40°C; humidity 10–90%; non-condensing
Housing	Robust metal housing with screw-on mounting brackets, network connectors on the front, dimensions 220 x 44 x 134 mm (W x H x D)
Number of fans	None; fanless design without rotating parts, high MTBF

Interfaces	
ETH	8 TP Ethernet ports 10 / 100 / 1000 Mbps 2 SFP ports 100 / 1000 Mbps 12 concurrent ports in total
Console	1 RJ-45

Package Content	
Mounting brackets	Two 19" brackets for rack mounting
Cable	IEC power cord, serial configuration cable 1.5 m

Hereby, LANCOM Systems GmbH | Adenauerstrasse 20/B2 | D-52146 Wuerselen, declares that this device is in compliance with Directives 2014/30/EU, 2014/35/EU, 2011/65/EU, and Regulation (EC) No. 1907/2006. The full text of the EU Declaration of Conformity is available at the following Internet address: www.lancom-systems.com/doc