

Mounting Instructions

# LANCOM Wall Mount LX-6500(E)

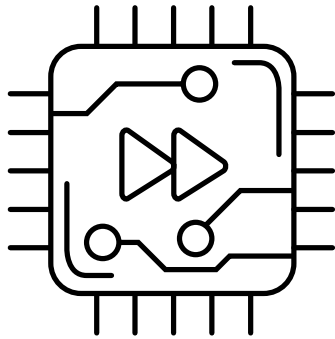

## General notes

The LANCOM Wall Mount LX-6500(E) is intended exclusively for mounting a LANCOM LX-6500(E) access point in a vertical wall or horizontal ceiling installation.

The bracket must be mounted on a solid, non-bendable / non-stretchable surface.

Mounting on (roof) slopes or corrugated roofs, as well as installation in other mounting directions or angles, is not permitted or recommended without additional securing of the access point to the bracket.

The bracket is fastened using 4 screws ② in the corners of the bracket or 2 screws ③ on the sides of the bracket.

## Preparing the Wall Mount LX-6500(E) for wall mounting

For wall mounting, the bracket must be aligned so that the latching spring ① is at the top.

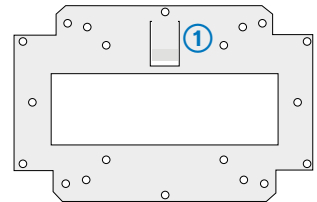

## Preparing the Wall Mount LX-6500(E) for ceiling mounting

Basically, it is mandatory to secure the access point in ceiling mounting with at least one separately available Kensington lock and/or LANCOM Lock and a padlock.

When mounting on a flat ceiling, use only the four outer holes ② for fastening.

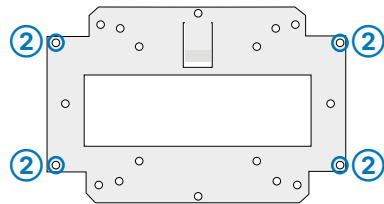

When mounting with LANCOM T-Bar Mount (LN) (e.g. on suspended ceilings), make sure that only the two outer holes ③ are used for mounting.

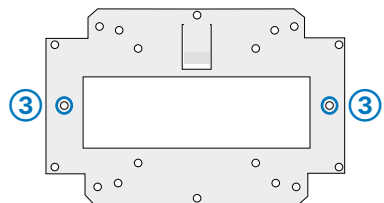

### Mounting the Wall Mount LX-6500(E)

Use the Wall Mount LX-6500(E) as a drilling template.

Select the appropriate mounting holes **2** or **3** depending on the mounting type and location.

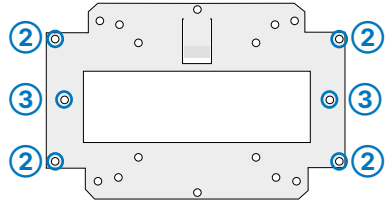

### Attaching the access point

When positioning the access point, guide the cables upwards out of the access point housing.

As shown in the illustration, push the access point onto the Wall Mount LX-6500(E) as far as it will go.

Then press the access point down until it audibly clicks into place.

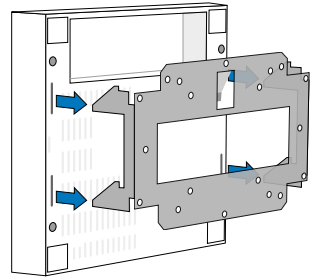

### Securing the access point

Secure the access point using the separately available LANCOM Lock and padlock.

As shown in the illustration, insert the locking device into one of the holes provided when open. Connect the housing and Wall Mount LX-6500(E) by pressing both halves of the LANCOM Lock together. Make sure that both holes of the lock are aligned.

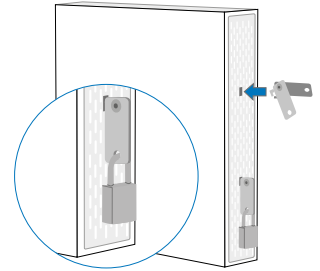

Finally, secure the LANCOM Lock with the enclosed padlock.

### Removing the access point

To detach the device from the Wall Mount LX-6500(E), please remove the padlock and LANCOM Lock first. To do this, carry out the previous steps in reverse order.

Release the lock using a tool (e.g. screwdriver). Push the tool in the direction of the wall and hold it in this position. Disconnect the Wall Mount LX-6500(E) by first pushing the access point upwards and then pulling it off towards the front.

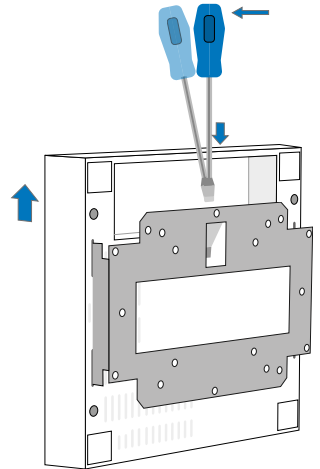

LANCOM Systems GmbH  
A Rohde & Schwarz Company  
Adenauerstr. 20/B2

52146 Wuersele | Germany  
[info@lancom.de](mailto:info@lancom.de) | [lancom-systems.com](http://lancom-systems.com)

LANCOM, LANCOM Systems, LCOS, LANcommunity and Hyper Integration are registered trademarks. All other names or descriptions used may be trademarks or registered trademarks of their owners. This document contains statements relating to future products and their attributes. LANCOM Systems reserves the right to change these without notice. No liability for technical errors and/or omissions. 112313 03/2025